

MS5 47 mm Heavy Duty Roller Blinds



MS5 47 mm Heavy Duty Roller Blinds

The MS5 47 mm Heavy Duty Roller Blinds present a superb resolution for managing both light and glare. With versatility, distinction, and affordability as key features, our product line offers an extensive selection of fabrics, all expertly fitted onto top-tier hardware components.

MS5 roller blinds system that allows easier operation of relatively large fabrics.

- Can handle up to 8 m² fabric, 4 kg load
- 2.5 meters maximum width (manual)
- Smooth and silent operation
- Metal control chain compatible
- Tested for 10,000 cycles
- Can be installed in any solution

Max dimensions on manual control

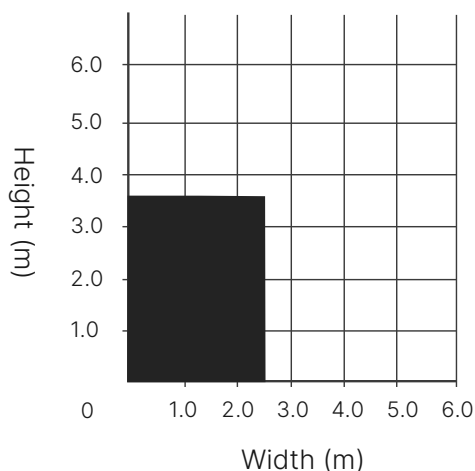

Compatible Sunscreen Fabrics

- PVC/PES (standard)
- New-gen PVC free 100%PES
- Screen with aluminum back cover
- Fiberglass/PVC
- Acoustic Screen

Fabric Options



Sunscreen



Dimout



Blackout

Trend products comply with EU directives regarding blinds, shades and shutters, EN 14501 Thermal and visual comfort – Performance characteristics and classification”, EN 13120 “Internal blinds - Performance requirements including safety”

Fabrics fully support Leed green buildings.

Products are 100% environment-friendly and recyclable.



Components

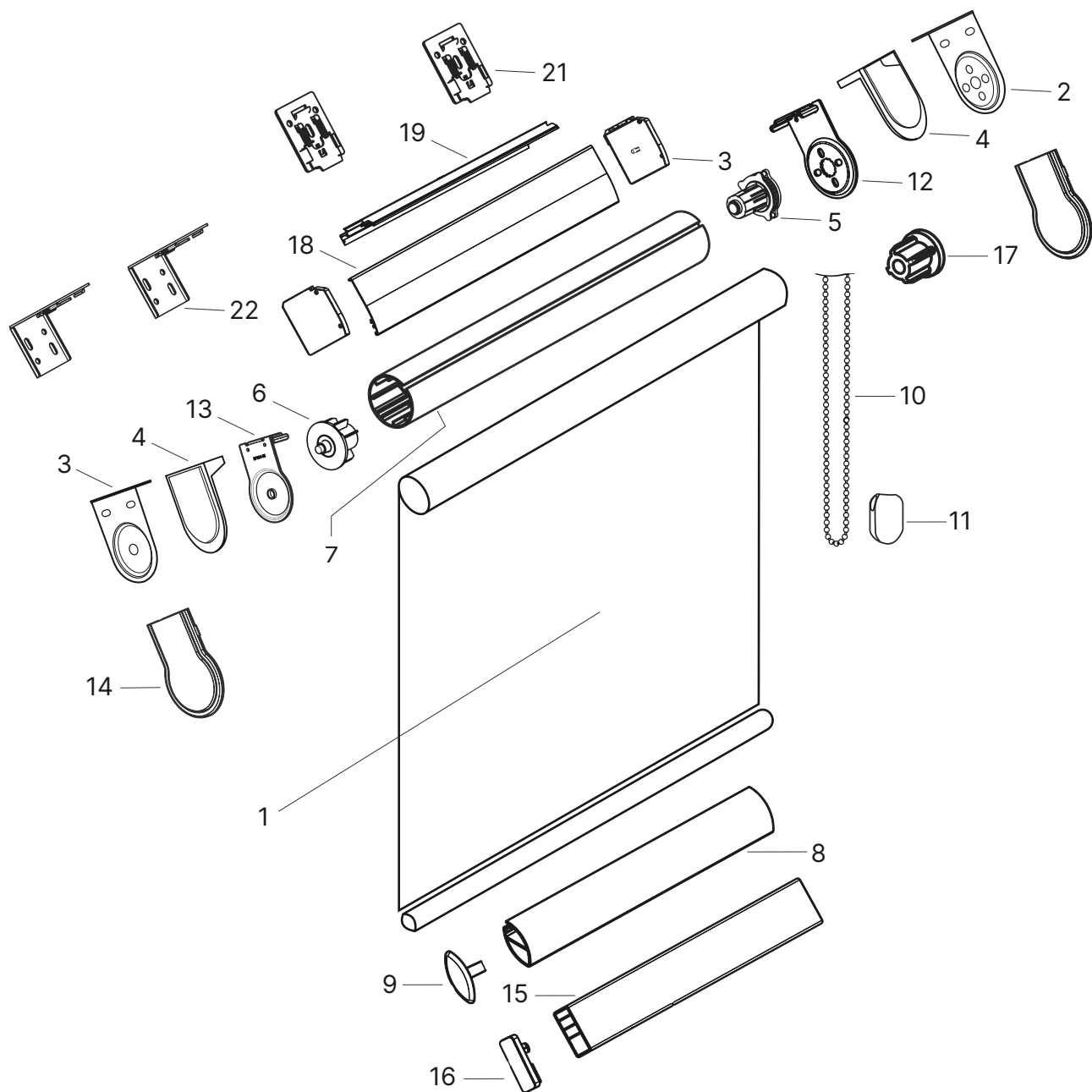

1. Fabric
2. Side Bracket - Metal Square
3. Side Bracket - Metal Square
4. Side Bracket - Metal Round
5. Gear 47 mm with Reducer&Bearing for Metal side Bracket
6. End Plug 47 mm with Bearing & Pin
7. Aluminium Roller Tube 47 mm
8. Aluminium Bottom Profile
9. End Cap

10. Ø4,5 mm Endless Chain 3M
11. Cover Control Set
12. Metal Side Bracket
13. Metal Side Bracket
14. Metal Engine Cover
15. Aluminium Bottom Endclosed
16. End Cap
17. Steel Ceiling Bracket for 47 mm Rail
18. Aluminium Cover for 100 mm
19. Aluminium Headrail 100 mm
20. End Caps Right &Left
21. Ceiling Bracket with Spring
22. Wall Bracket with Spring

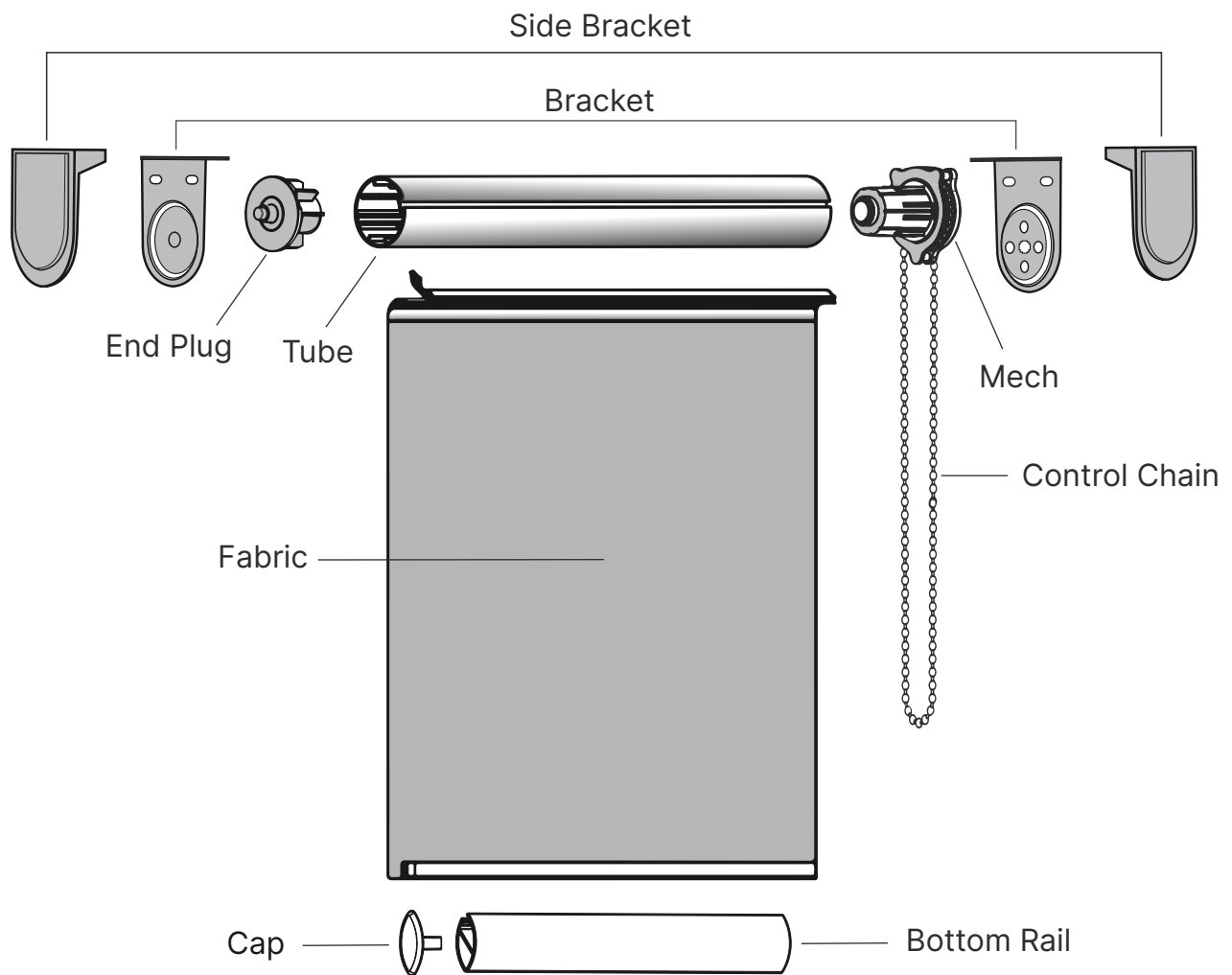

End Plug

Redesigned end plug lessens the friction allowing a smoother and quieter control of the blind and improving product life

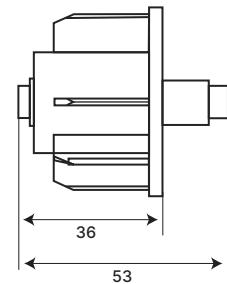
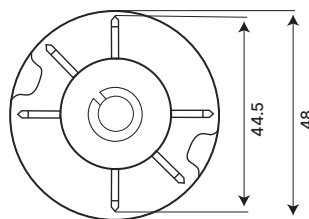

Mech

Heavy duty mech with 4:1 Gear
Easy and silent operation
Built-in spring assist

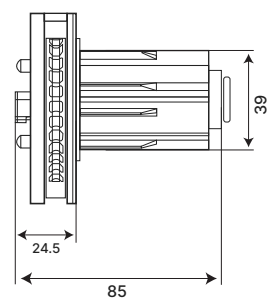
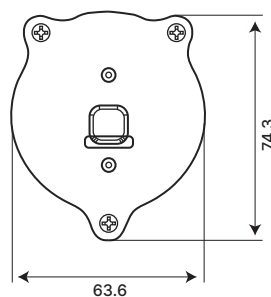

Side Bracket - Metal
Square

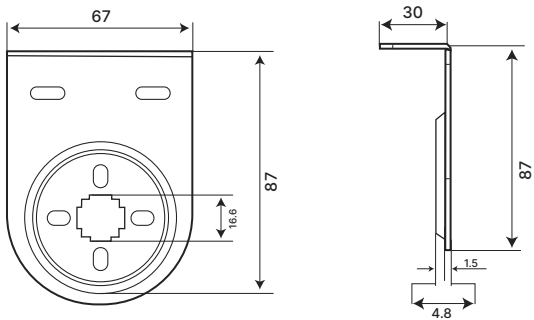

Side Bracket - Metal
Square

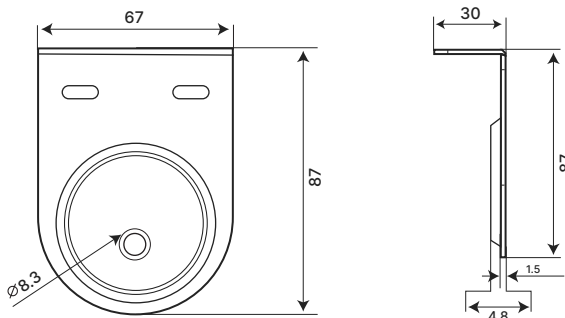

Side Bracket - Metal
Round

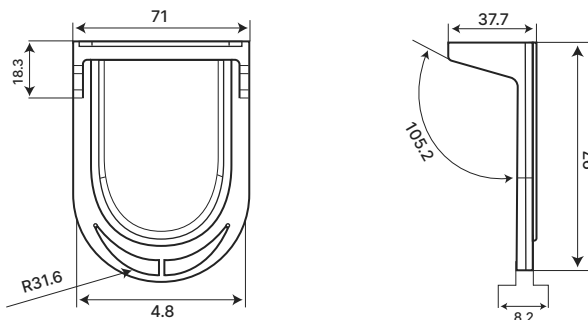

Control Chain
4.5 mm wide plastic
and metal chains are
supported

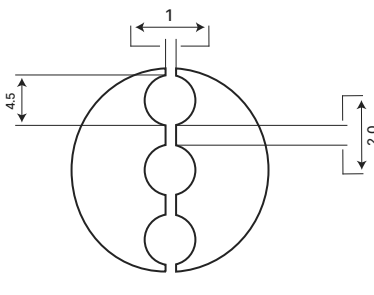

Cassette Box

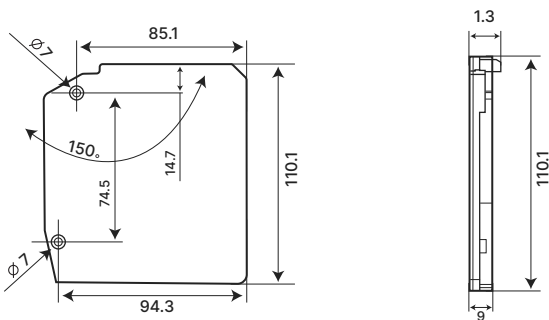

New 389 spring steel bracket

New 389 spring steel bracket makes the installation of cassette box easier and improves system stability

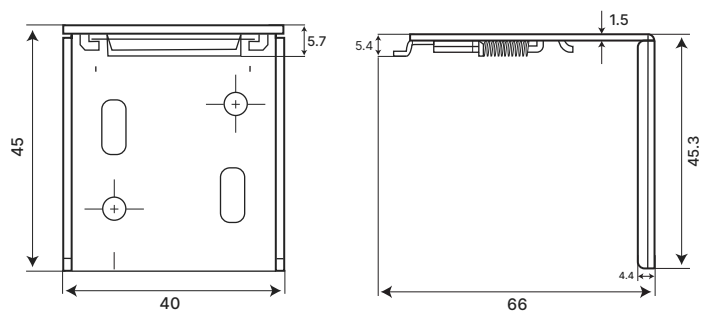

Wire guidance

Wire guidance can be fixed to the ground or wall/frame

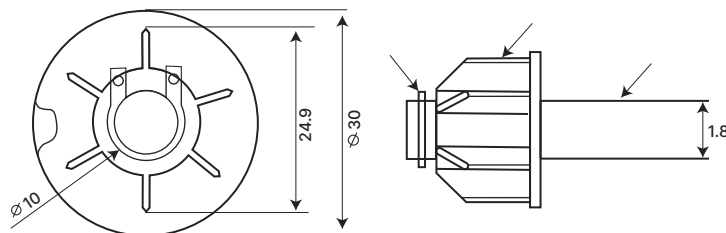

Bottom Rail

Rectangular bottom rail particularly useful for heavy fabrics. Unlike standard bottom rail this can't be concealed with fabric.

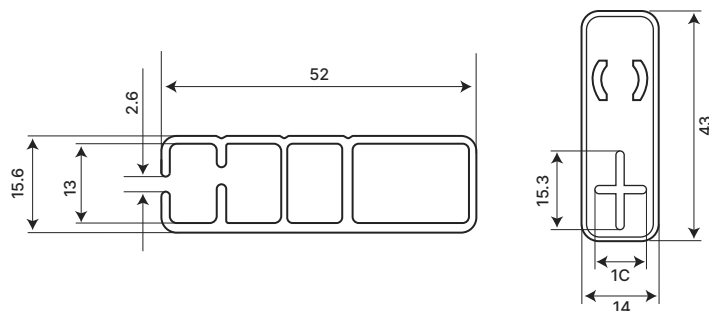

Aluminium Roller Tube 47

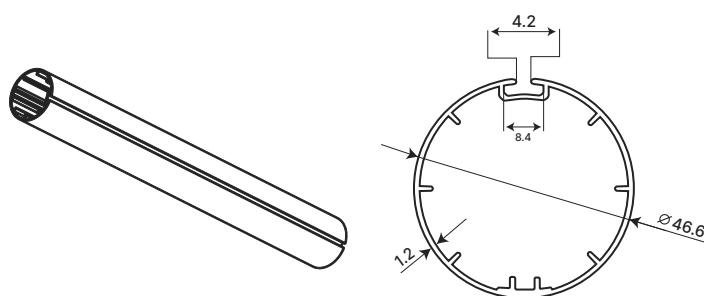

Click Steel Bracket

This is an alternative system to side brackets. Allows easier installation, puts less pressure on accurate measurements. And can be installed to both ceiling and wall via brackets

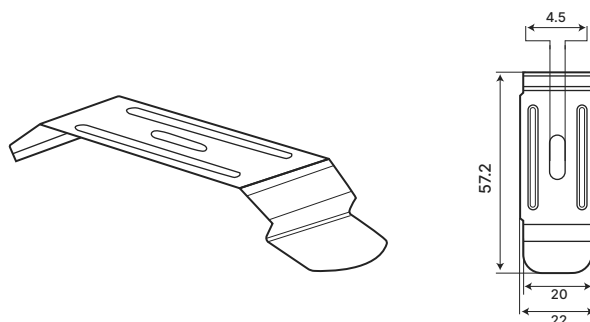

0090 216 327 0727

trendperde.com.tr

sales@trendperde.com.tr